

Series V2001 Valves: Type 3535 Three-way Valve for heat transfer oil

Your contact details:

Title:

Name:

Company:

Customer no.

Street:

ZIP/postal code, city:

Country:

E-mail:

Phone:

Ordering spare parts

The spare parts for Type 3535 are listed on the next pages. This document can also be used for ordering:

1. Fill in your contact data and information on the product.
2. Enter the quantity of spare parts needed.
3. Click [Send form] button to attach the PDF form to an e-mail.
4. Attach additional information (e.g. invoice, photos) to the e-mail, if necessary.
5. Send e-mail to spareparts@samson.de.

Either

Configuration ID (Var-ID):

or

SAMSON order no.:

Position in order:

or

SAMSON 2 Var.-ID 3 1 No K_v 5 EAC
 6 bar DN 7 PN 8 Δp 9 bar T 10 °C 11
Made in Germany

1	Type designation:	<input type="text"/> 3535
2	Model no. with index:	<input type="text"/>
3	Configuration ID:	<input type="text"/>
5	Flow coefficient:	<input type="text"/>
6	Set point range/spring force:	<input type="text"/>
7	Valve size:	<input type="text"/>
8	Pressure rating:	<input type="text"/>
9	Perm. differential pressure:	<input type="text"/>
10	Perm. temperature:	<input type="text"/>
11	Body material:	<input type="text"/>
Version		Mixing valve Diverting valve

Send form

Print form

Clear form

Edition April 2018

Spare parts list

EL 8135 EN

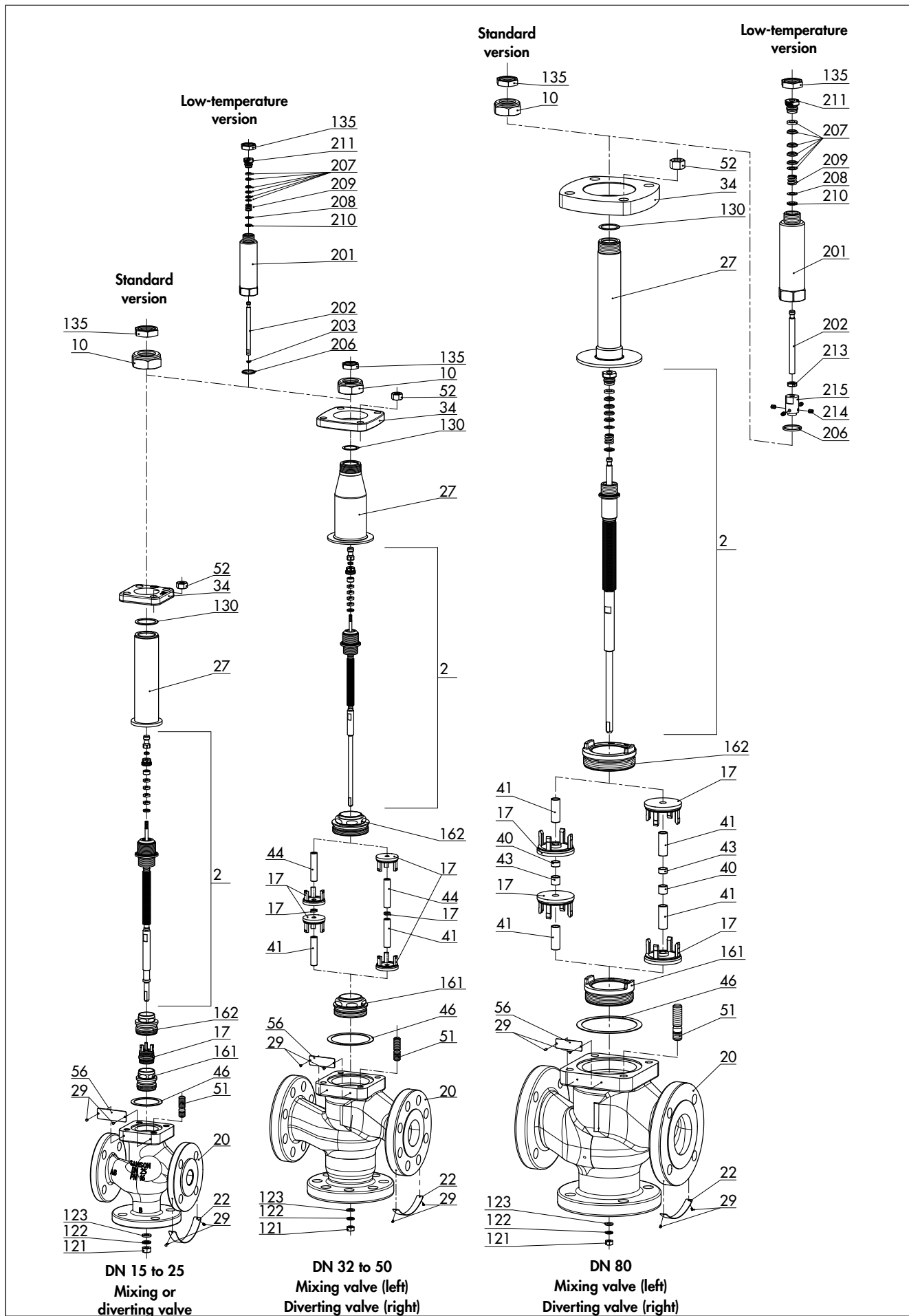

Spare part no.	Qty.	Filled in by SAMSON: item number
2 Plug stem with metal bellows seal		
10 Coupling nut		
11 Hex nut		
12 Retaining washer		
13 Washer		
17 Plug		
20 Body		
22 Nameplate		
27 Flanged pipe		
29 Grooved pin		
34 Flange		
40 Pipe		
41 Pipe		
43 Pipe		
44 Pipe		
46 Seal (graphite)		
51 Stud		
52 Hex nut		
56 Label (mixing valve)		
121 Hex nut		
122 Retaining washer		
123 Washer		
130 Gasket		
135 Nut		
161 Seat		
162 Seat		
201 Pipe		
202 Stem		
203 Hex nut		
206 Seal (PTFE)		
207 V-ring packing		
208 Washer		
209 Compression spring		
210 Washer		
211 Threaded bushing		

Spare part no.	Qty.	Filled in by SAMSON: item number
213 Hex nut		
214 Threaded pin		
215 Nipple		

Specifications subject to change without notice



SAMSON AG · MESS- UND REGELTECHNIK
Weismüllerstraße 3 · 60314 Frankfurt am Main, Germany
Phone: +49 69 4009-0 · Fax: +49 69 4009-1507
samson@samson.de · www.samson.de

EL 8135 EN

2020-01-07 · English